

Installation Instructions

100288-000



FIRST LIGHT
SAFETY PRODUCTS

RIVET NUT INSTALLATION TOOL

RIVET NUT INSTALLATION TOOL

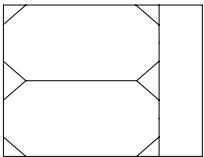
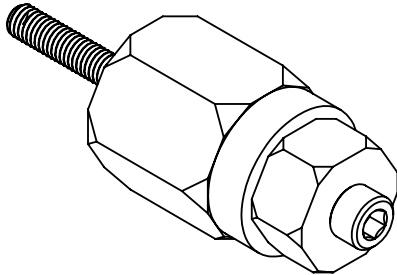

Tool Base
A x 1

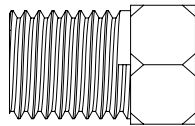

Tool Top
B x 1

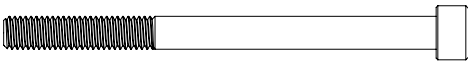

Center Bolt
C x 1

BILL OF MATERIALS

RIVET NUT INSTALLATION TOOL	QTY	REF
Tool Base	1	A
Tool Top	1	B
Center Bolt	1	C

REQUIRED TOOLS

- 5/32" Allen keys
- 25/64" Drill
- 7/8" Wrench
- 11/16" Wrench or socket

DISCLAIMER

IMPORTANT: PLEASE READ ALL INSTRUCTIONS CAREFULLY BEFORE INSTALLING, FAILURE TO DO SO MAY CAUSE PERSONAL INJURY OR DAMAGE TO PRODUCT AND/OR PROPERTY.

This manual has been created for basic informational purposes only. The activities described herein can be dangerous unless proper safety precautions are taken. If you are not comfortable or are inexperienced with the processes and tools described in this manual, you should not attempt to install the product. These instructions do not purport to cover all details or variations in the equipment and do not claim to provide for every possible contingency met in connection with the installation. Installation of this product should always be performed by a qualified technician and in accordance with safe work

procedures. First Light Safety Products (a division of Smartrend Supply Ltd., hereinafter "First Light Safety Products") shall not be held responsible for any errors or omissions respecting installation as they are the responsibility of the installing technician and/or the customer. First Light Safety Products does not make any representation, warranty, guarantee or condition respecting third-party installation or any other service provided by a third-party, and any such representations perceived by the reader/customer are hereby fully disclaimed.

Any reliance on this manual is solely at the risk of the customer/reader. First Light Safety Products assumes no responsibility for other's use of this manual and hereby expressly disclaims any and all liability to any party for any direct, indirect, implied, punitive, special, incidental or other consequential damages arising directly or indirectly from any improper or incorrect use of this manual.

Rivet Nut Installation Tool

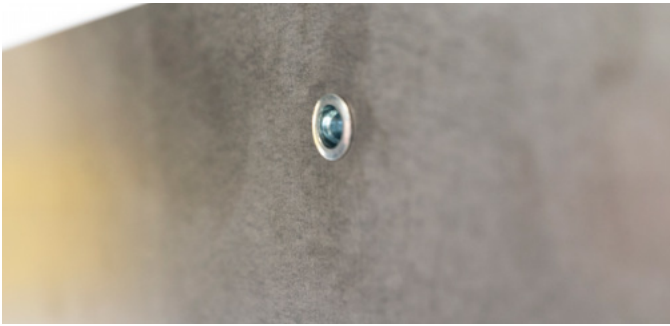

STEP 1

- i. Drill hole to 25/64".
- ii. Insert Rivet nut into hole.



STEP 3

- i. Place a 7/8" wrench over the body of the Rivet Nut Installation Tool.



STEP 5

- i. Once the torque becomes excessive the Rivet nut is seated.
NOTE: Recommended torque is 124 in-lbs (+/- 20 in-lbs)
- ii. Remove the Center Bolt (C) using a 5/32" Allen key.
- iii. The Rivet Nut should sit flush and tight to the panel when installed correctly.



STEP 2

- i. With the Tool Top (B) fully threaded in, pass the Center Bolt (C) through the tool and thread is into the Rivet nut.



STEP 4

- i. Tighten the Center Bolt (C) with an 11/16" socket while pressing against the Rivet nut to keep it flat against the surface.



Visit our website for video instructions and additional supporting documentation:

www.firstlightsafety.com/resources

If further help is needed, please contact us:

Technical Support - Mon - Fri, 8a.m. to 5p.m. CST

E: techsupport@firstlightsafety.com

P: 866.216.2605